



## Front Lower Control Arm Bushing Removal/Installation Tool - Instructions for use.

Assembly #:2260020

### Cars applicable:

964 / 993

### Parts list:

| Quantity | Description              |
|----------|--------------------------|
| 1        | Cup                      |
| 1        | Piston                   |
| 1        | Threaded Rod             |
| 2        | M10 Hex nut              |
| 2        | M10 Standard Flat Washer |

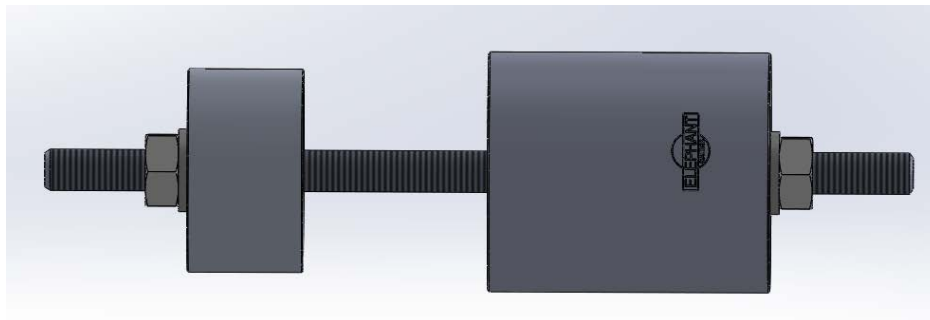

**Elephant Racing Part No. 2260020: Bushing Removal Tool Assembly**

### Tools Required:

- 15 mm deep socket
- 15mm wrench

### Introduction:

We understand that the task of removing the control arm, pressing the old bushings out, and the new ones in can be a daunting task. That's why Elephant Racing has devised a set of tools to make removing your old bushings and installing your new inserts as easy as possible. Now there's no need to remove the control arm completely from the vehicle!

**Step-by-Step Instructions:**

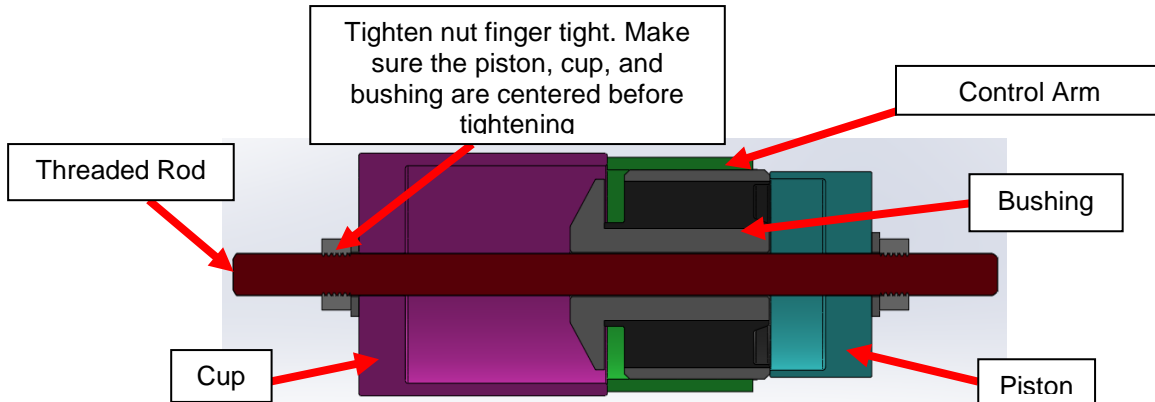

**Figure 1: Removal Tool and Bushing Assembly**

**Bushing Removal**

1 – Disconnect the lower control arm from the chassis. Refer to an appropriate shop manual for more detailed instructions.

2 – Note: Mark the position of the bushing key before removal.

Position the parts and tools as shown in Figure 1. Using two wrenches, tighten the nuts; this will draw the bushing into the cup.



**Bushing Installation**

1 – The bushing should be installed from the front side of the control arm. Make sure to align the key with the mark you made in step 2. Slide the threaded rod through the piston, bushing, control arm, and removal cup. Install the nuts and washers on either side of the assembly and tighten finger tight.

2 – Use two wrenches to tighten the nuts. Ensure the bushing is concentric as it is drawn into the wheel carrier. Continue tightening the nut until the bushing is positioned appropriately in the wheel upright. See Figure 1 for a depiction of an installed bushing.